

SERIES 39/38 ANSI RANGE

Check Valves are self-acting valves used for preventing the reverse of flow in a piping system. Series 39 are Forged Swing Check Valves that operate by means of its articulated disc. They are featured by its rugged and compact design and easy maintenance.

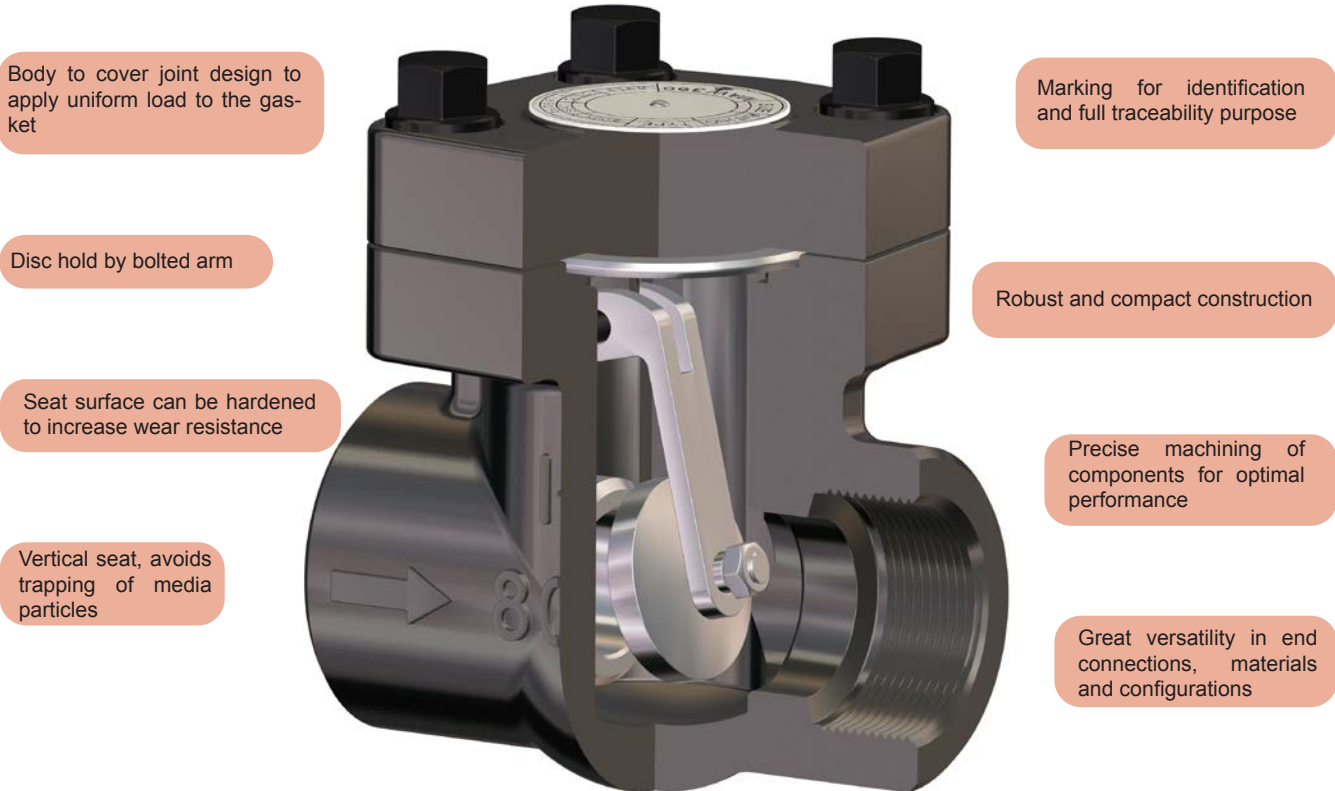

Body to cover joint design to apply uniform load to the gasket

Marking for identification and full traceability purpose

Disc hold by bolted arm

Robust and compact construction

Seat surface can be hardened to increase wear resistance

Precise machining of components for optimal performance

Vertical seat, avoids trapping of media particles

Great versatility in end connections, materials and configurations

Main Features / Reference Standards

Design: API 602
 Pressure Rating: 800/1500/2500#
 Face to face length: Manufacturer standard
 Valve end connections: Threaded NPT to ASME B1.20.1 / BSP to ISO 228-1 / BSPT to ISO 7-1
 Welded SW to ASME B16.11
 Marking: MSS SP-25
 Inspections & Tests: API 598
 Zinc phosphated surface protection for forged steel valves
 Product compliant with Directive 2014/68/EU on Pressure Equipment (PED) for European Union territory

Main Duties / Limits of use

Fluids compatible with materials of construction. Questions referring to chemical resistance, please consult us
 Pressure / Temperature Rating to ASME B16.34. See section "Engineering & Performance Data"
 For products compliant with Directive 2014/68/EU, observe also limits acc. to Annex II tables 6 & 8 (gases & liquids group 1*) and tables 7 & 9 (gases & liquids group 2*) up to category III
 *Classification of fluids (group 1 or 2) acc. to Directive 2014/68/EU, Article 13

Options

Diverse body materials and trim combinations, different valve connections, pressure seal, welded bonnet... Please consult us

Main Parts and Materials

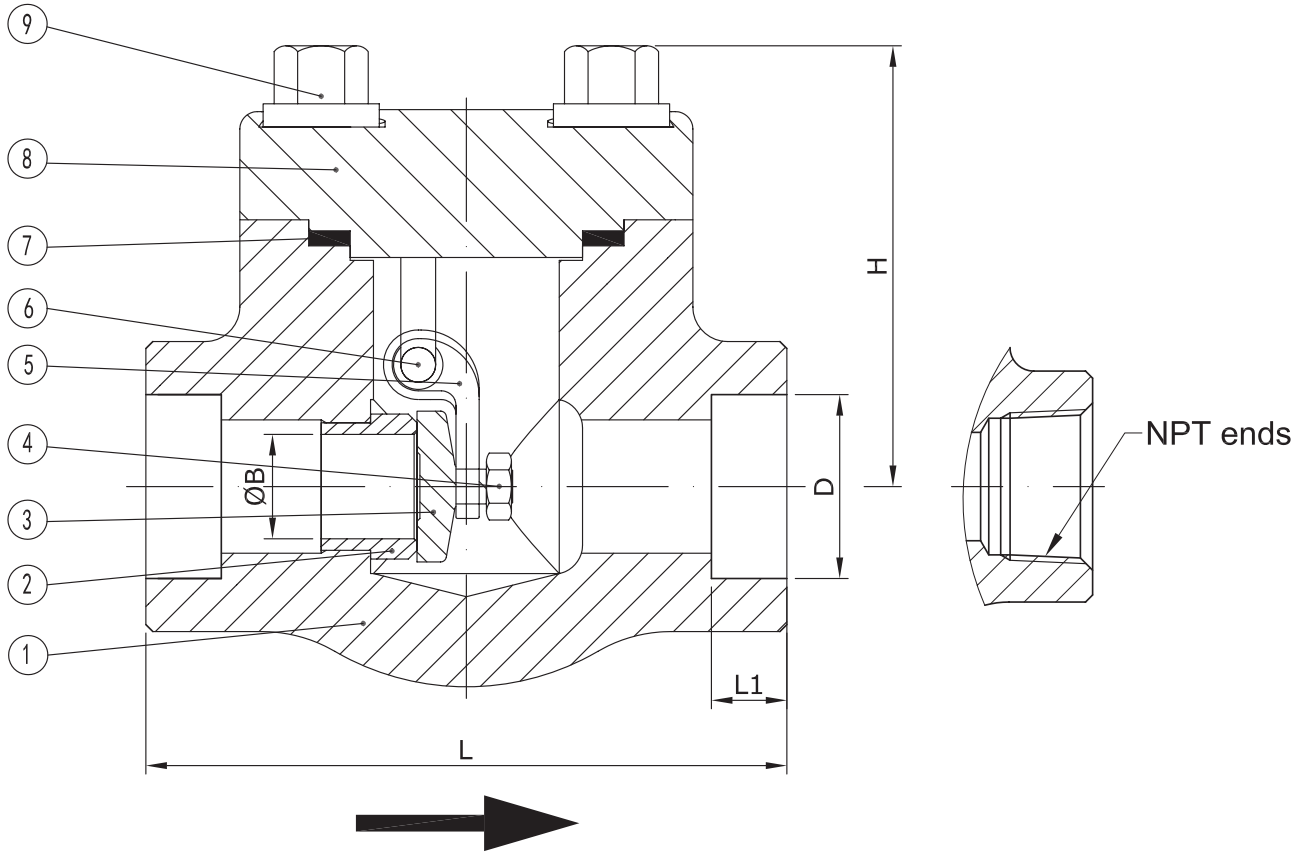

N°	PART	MATERIAL								
		A105N			A350 LF2		A182 F11/F22	A182 F304/F304L	A182 F316/F316L	A182 F51/F53
		Trim 1 (39A01)	Trim 5 (39A05)	Trim 8 (39A08)	Trim 2 (39A12)	Trim 10 (39A1D)	Trim 5 (39B75/39B65)	(39I10/39I90)	(39I30/39J10)	(39K30/39K40)
1	Body	A105N			A350 LF2		A182 F11/F22	A182 F304(L)	A182 F316(L)	A182 F51/F53
2	Seat	A276 410	A276 410+HF	A276 410+HF	A276 304	A276 316	A276 410+HF	A276 304(L)	A276 316(L)	A182 F51/F53
3	Disc	A182 F6a	A182 F6a+HF	A182 F6a	A182 F304	A182 F316	A182 F6a+HF	A182 F304(L)	A182 F316(L)	A182 F51/F53
4	Disc Nut	A194 2H			A194 4		A194 4	A194 8(M)	A194 8M	A194 8M
5	Hinge	SS304			SS304		SS304	SS304	SS316	SS316
6	Hinge Pin	A276 410			A276 304		A276 410	A276 304(L)	A276 316(L)	A182 F51/F53
7	Cover Gasket	SS304+Graphite			SS304+Graphite	SS316+Graphite	SS304+Graphite	SS304+Graphite	SS316+Graphite	SS316+Graphite
8	Cover	A105N			A350 LF2		A182 F11/F22	A182 F304(L)	A182 F316(L)	A182 F51/F53
9	Cover Bolt	A193 B7			A320 L7		A193 B16	A193 B8(M)	A193 B8M	A193 B8M

Main Valve Parameters

Class 800

Nominal Size		inch	3/8"	1/2"	3/4"	1"	1 1/4"	1 1/2"	2"	
DN			10	15	20	25	32	40	50	
End connection	Threaded	NPT/ BSP/BSPT	L	79	79	92	111	120	120	140
			ØB	8	10,5	13,5	18	23	29	36,5
End connection	Socket weld	SW	L	79	79	92	111	120	120	140
			L1	9,6	9,6	12,7	12,7	12,7	12,7	16
			ØB	8	10,5	13,5	18	23	29	36,5
			ØD	17,6	21,8	27,1	33,8	42,6	48,7	61,2
			H	61	61	61	78	84	84	120
Kvs-value			-	3,9	6,3	12,1	21,5	31,4	51	
Approx. Weight Threaded/SW			1,4	1,5	1,7	3,3	4,2	4,2	8,5	

Dimensions in mm subject to manufacturing tolerance / Kvs-values in m³/h / Weights in kg

Class 1500

Nominal Size		inch	3/8"	1/2"	3/4"	1"	1 1/4"	1 1/2"	2"	
DN			10	15	20	25	32	40	50	
End connection	Threaded	NPT/ BSP/BSPT	L	92	111	111	120	120	140	178
			ØB	8	10,5	13,5	18	23	29	36,5
End connection	Socket weld	SW	L	92	111	111	120	120	140	178
			L1	9,6	9,6	12,7	12,7	12,7	12,7	16
			ØB	8	10,5	13,5	18	23	29	36,5
			ØD	17,6	21,8	27,1	33,8	42,6	48,7	61,2
			H	61	78	78	84	103	120	133
Kvs-value			-	3,9	6,3	12,1	21,5	31,4	51	
Approx. Weight Threaded/SW			1,5	3,2	3,3	4,2	5	8,5	10,9	

Dimensions in mm subject to manufacturing tolerance / Kvs-values in m³/h / Weights in kg

Main Parts and Materials

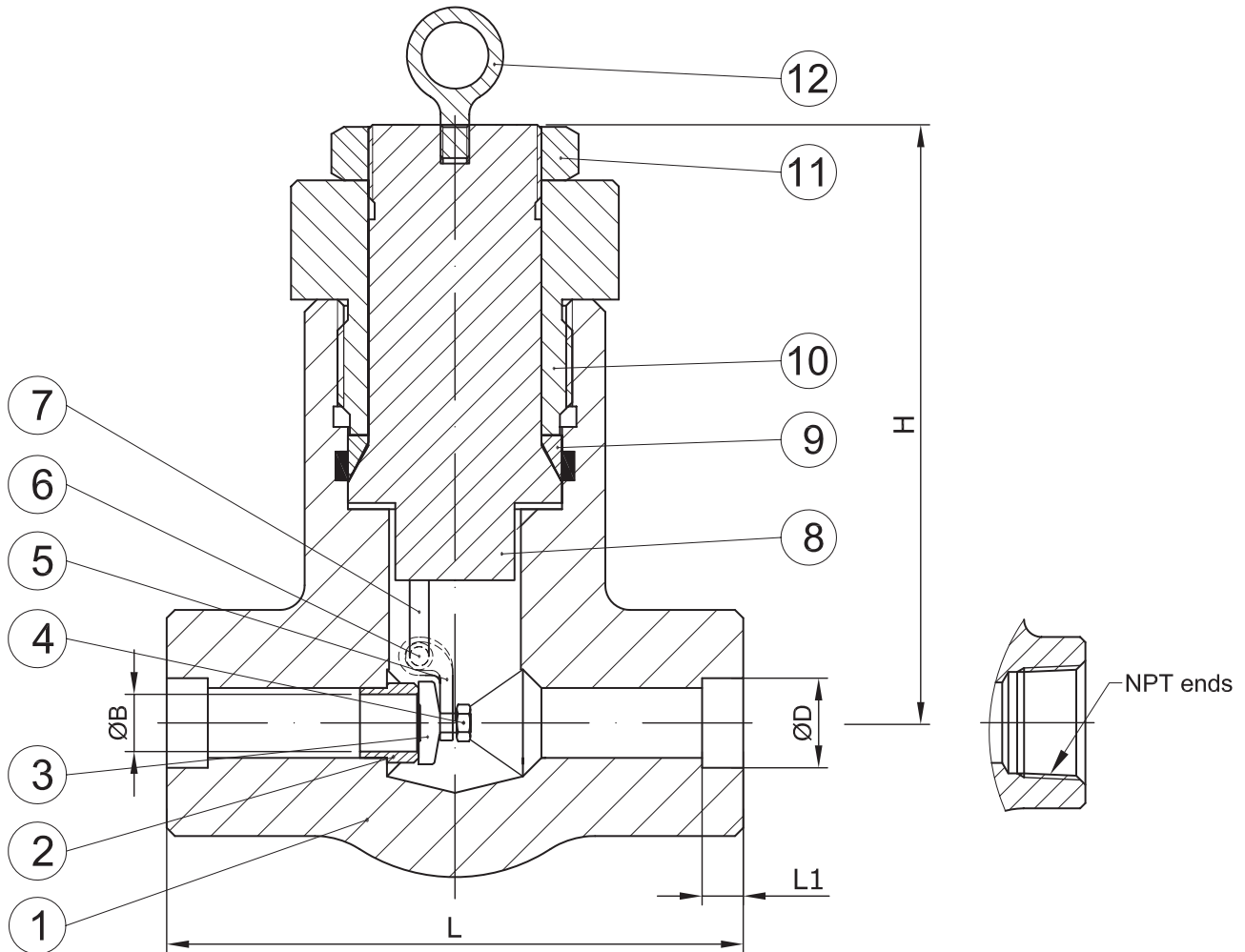

N°	PART	MATERIAL								
		A105N			A350 LF2		A182 F11/F22	A182 F304/F304L	A182 F316/F316L	A182 F51/F53
		Trim 1 (38A01)	Trim 5 (38A05)	Trim 8 (38A08)	Trim 2 (38A12)	Trim 10 (38A1D)	Trim 5 (38B75/38B65)	(38I10/38I90)	(38I30/38J10)	(38K30/38K40)
1	Body	A105N			A350 LF2		A182 F11/F22	A182 F304(L)	A182 F316(L)	A182 F51/F53
2	Seat	A276 410	A276 410+HF	A276 410+HF	A276 304	A276 316	A276 410+HF	A276 304(L)	A276 316(L)	A182 F51/F53
3	Disc	A182 F6a	A182 F6a+HF	A182 F6a	A182 F304	A182 F316	A182 F6a+HF	A182 F304(L)	A182 F316(L)	A182 F51/F53
4	Disc Nut	A194 2H			A194 4		A194 4	A194 8(M)	A194 8M	A194 8M
5	Hinge	SS304			SS304		SS304	SS304	SS316	SS316
6	Hinge Pin	A276 410			A276 304	A276 316	A276 410	A276 304(L)	A276 316(L)	A182 F51/F53
7	Positioner	A276 410			A276 304	A276 316	A276 410	A276 304(L)	A276 316(L)	A182 F51/F53
8	Seal Nut	A276 420			A276 304	A276 316	A276 420	A276 304(L)	A276 316(L)	A182 F51/F53
9	Gasket	A276 304			A276 304		A276 304	A276 304(L)	A276 316(L)	A182 F51/F53
10	Cover	A105N			A350 LF2		A182 F11/F22	A182 F304(L)	A182 F316(L)	A182 F51/F53
11	Lock Nut	Carbon Steel			Carbon Steel		Carbon Steel	St. Steel	St. Steel	St. Steel
12	Lift Ring	Carbon Steel			Carbon Steel		Carbon Steel	Carbon Steel	Carbon Steel	Carbon Steel

HF = Hard faced

Main Valve Parameters

Class 2500

Nominal Size		inch	3/8"	1/2"	3/4"	1"	1 1/4"	1 1/2"	2"	
DN			10	15	20	25	32	40	50	
End connection	Threaded	NPT/ BSP/BSPT	L	186	186	186	186	230	230	275
			ØB	8	10,5	13,5	18	23	29	36,5
End connection	Socket weld	SW	L	186	186	186	186	230	230	275
			L1	9,6	9,6	12,7	12,7	12,7	12,7	16
			ØB	8	10,5	13,5	18	23	29	36,5
			ØD	17,6	21,8	27,1	33,8	42,6	48,7	61,2
H			117	117	117	117	152	152	195	
Kvs-value			-	3,9	6,3	12,1	21,5	31,4	51	
Approx. Weight Threaded/SW			9	9	9	9	21	23	39	

Dimensions in mm subject to manufacturing tolerance / Kvs-values in m³/h / Weights in kg